



# ZODIAC

*The pleasure of **soft**  
**pure water**  
in less than **10 minutes***



Swimming pool  
**E**xpress salt water chlorinator







The pleasure of *soft  
pure water*  
in less than **10 minutes**

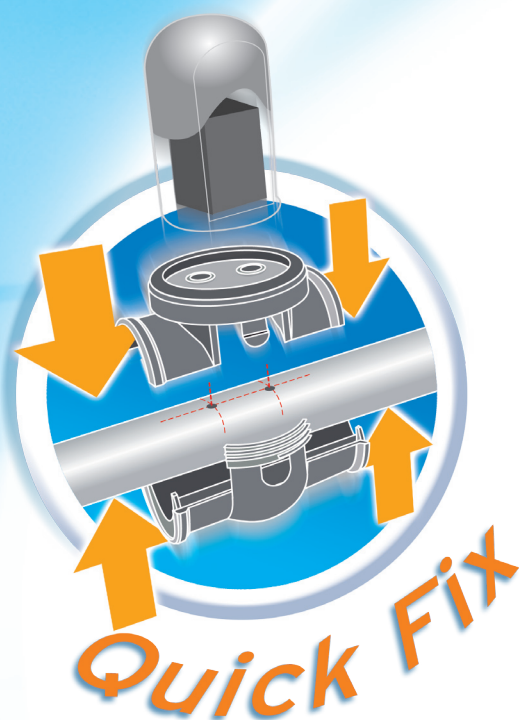

## Express salt water chlorinator

- Disinfectant produced directly by the **Ei®** cell
- Optimal disinfection even when you're away
- Quick and easy installation by the user
- Cell installed horizontally or vertically

Ei® can be installed in less than 10 minutes using the **Quick Fix** NO PLUMBING system.

Drill 2, Ø 20 mm holes in the filtration pipe work

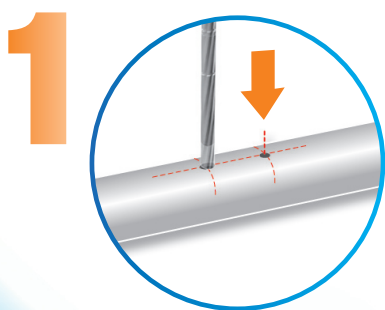

Clip the supporting collar on to the pipe work

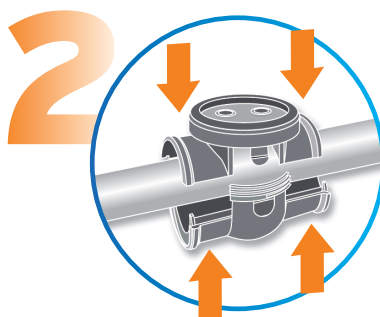

Position the cell and tighten the collars



### 2 installation possibilities



Horizontal cell installation

or



Vertical cell installation



## SAFE SYSTEM

The cell has a flow **detector**



## NO MAINTENANCE

Self-cleaning electrodes using **adjustable** polarity inversion



## RELIABILITY

- **Titanium Clearwater® technology electrodes** guarantee an optimal life span
- Whatever the cause of deterioration, the control box and the cell will be repaired or replaced during the **24 month period** following your purchase.



## EASY TO MONITOR

- User friendly control panel
- **Programmable clock** in order to adjust filtration times and chlorine production independently



## For optimal bathing comfort!

Add the pH controller "**pH Perfect**" to your **Ei®** salt water chlorinator.





## Ei®, HOW DOES IT WORK?

Salt Water Chlorination is simple.

The pool water is very slightly salty:

4 g/l (9 times less than sea water).

- The salt water chlorinator is installed on the pool's filtration system.

**The salt is converted to chlorine**, a powerful disinfectant, by the cell and **immediately dissolved in the water**.

- The chlorine produced is used to fight against bacteria, algae and micro-organisms.
- The chlorine that is eliminated by the UV effects of sunlight is permanently renewed by the cell **without any further intervention**.

**Ei® is adapted to all types of swimming pools and pool surfaces, for use on existing pools and pool's with small technical facilities.**

## 3 AVAILABLE MODELS:

	Ei® 10	Ei® 17	Ei® 25
Chlorine production	10 g/h	17 g/h	25 g/h
Water volume (calculated volume for 8h of filtration)	40 m³	70 m³	100 m³

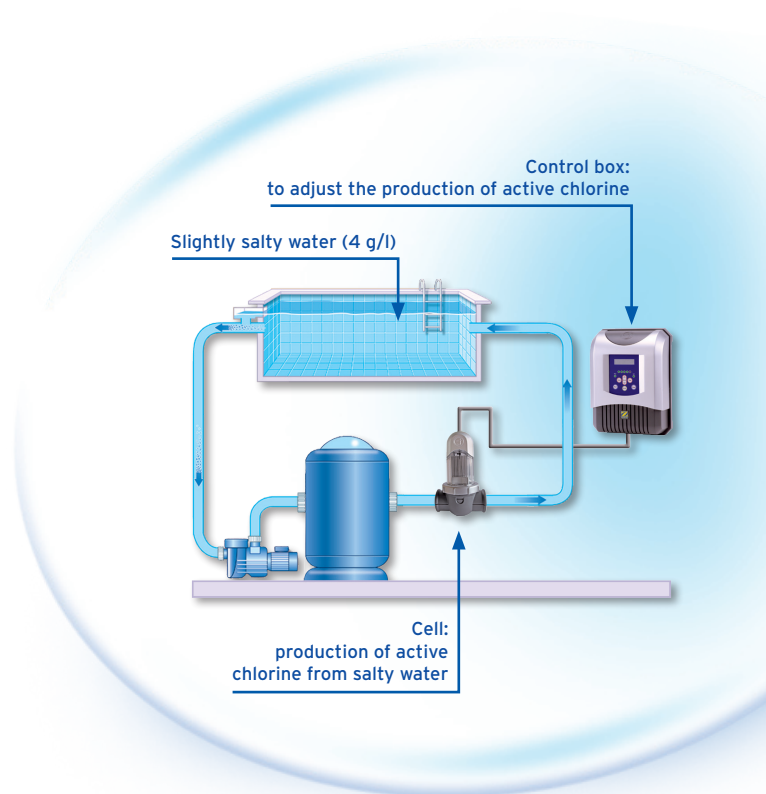

## TECHNICAL CHARACTERISTICS:

- Power supply: 220-240 VAC (50 Hz)
- Minimum flow: 5 m³/h
- Maximum flow: over 18 m³/h, the processing cell must be installed on a by-pass
- Maximum authorized cell pressure: 275 kPa = 2,75 bars
- Maximum water temperature: 40°C
- Minimum salt level required: 3 g/l (Recommended rate 4 g/l)
- Optimisation of titanium electrode performances, using an exclusive alloy, in the polarity inversion (every 2h30 or 5h) in hard water areas
- Cell position: cell body vertical or horizontal (with flow detector)
- Cell size (L x H): 162 x 270 mm
- Length of the cable between the cell and the box = 1,8 m
- Protection index = IP 24

Zodiac Pool Care Europe  
Parc d'activités du Chêne  
2, rue Edison  
69500 BRON - France  
Tel. 33 (0)4 78 79 56 20  
Fax 33 (0)4 78 79 56 29  
zpce@zodiac.com

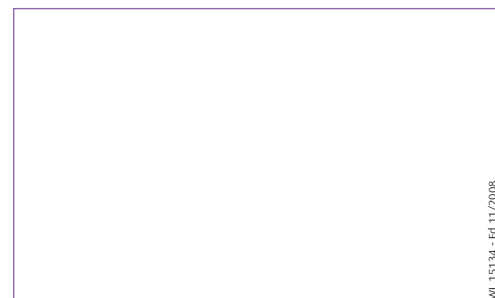

WL 15134 - Ed 11/2008